

FABRICATION OF COMPONENTS AS PER DWG.

Ref: MDF/LL//24/01/01/01

1. THE ORDER SHOULD NOT BE PREFERABLY SPLITTED. THE COMPREHENSIVE QUOTE CONSIDERING AVAILABILITY OF ALL COMPONENTS, FOR AT CSIO WILL BE CONSIDERED.
2. THE REQUIRED QUANTITY IS MENTIONED AND COMPONENTS SHOULD BE SEALED/PACKED AS PER THE ORIGINAL FACTORY PACKING. IF FOUND DAMAGED, WILL BE RETURNED.
3. THE PRICE SHOULD BE INCLUDING EX-CSIO DELIVERY.
4. THE VALID COC SHOULD BE SHARED.
5. PAYMENT AND OTHER THINGS AS PER CSIO NORMS
6. PL MAIL AT harry.garg@csio.res.in, pme@csio.res.in, sunil.kumar@csio.res.in
7. QUOTE TIME 7 DAYS FROM DATE OF TENDER.
8. THE DETAILS OF USER WILL NOT BE SHARED.
9. SUPPLIER/OEM TO SHARE THE DELIVERY TIMELINES AFTER PO AND PAYMENT TERMS.. PURCHASE OF COMPONENTS/ PO IS PURELY THE PREROGATIVE OF CSIO
10. PL QUOTE WITH 18% GST AND DELIVERY TIMELINES OF 30 DAYS. SHARE AND ATTACH RELEVANT COMPANY DOCUMENTS.
11. KINDLY FILL ALL THE RELEVANT FIELDS MENTIONED IN THE TENDER AND STRIKEOUT WHICHEVER IS NOT APPLICABLE.

OP 33M.01-11

DRG.NO.

IF IN DOUBT ASK

ISSUE	REVISION	CLASS
-------	----------	-------

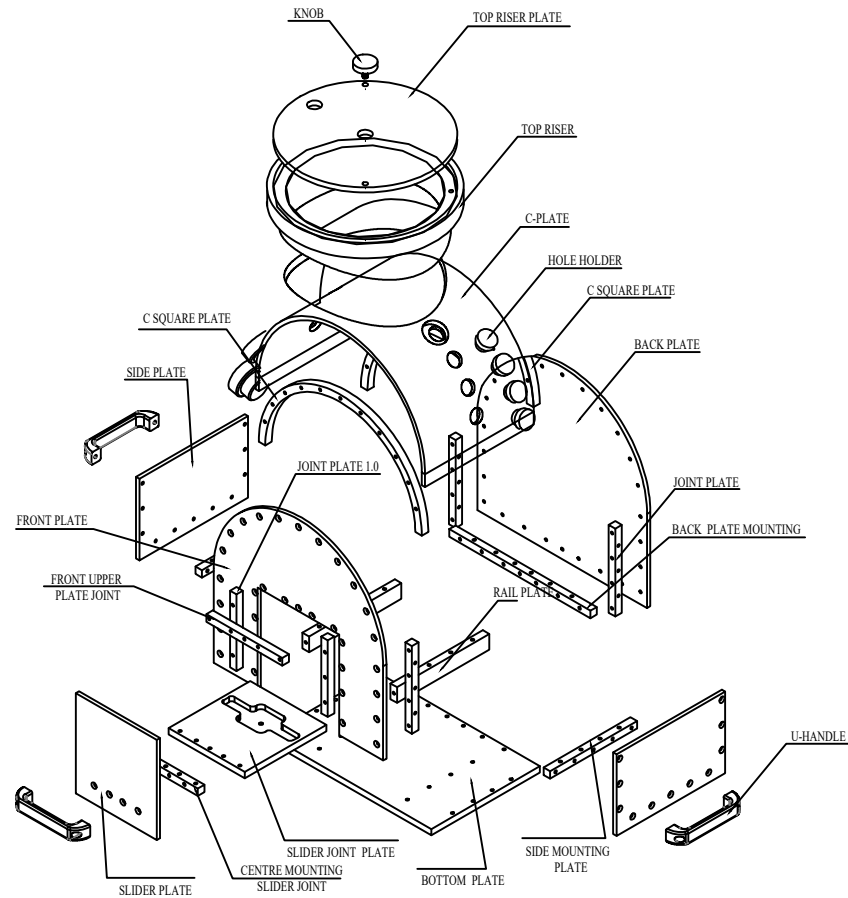

ISSUE	'A'					
DATE	00.00.0000					
REF.NO.	_____					
DRN.	name					
CHD.	name					
MATL.	name					
DQAG	name					
APPD.	name					

UNLESS OTHERWISE STATED

- DIMENSIONS ARE IN mm.
- LIMIT ± 0.2 ; $\pm 30'$
- SURFACE FINISH $\sqrt{16}$ (CLA)
- ROUND OFF SHARP EDGES
- METRIC THREADS AS PER IS:4218
- FINISHED SIZES SHOWN (AFTER PLATING)
- DO NOT SCALE

MATERIAL AL6061T6	SPEC. _____	HEAT TRT. _____	SPEC. _____	PROTECTIVE TRT. _____	SPEC. _____
	EST.WT.(g)	LL RIG - EXPLODED LAP LIGHT INTENSITY TEST RIG			
SCALE 1 : 5	SHEET 11 OF 20	ASSY.NO.			
	Aerospace Systems Equipment Research and Design Centre H A L, LUCKNOW		DRG.NO. OP 33M.01		

OP 33M.01-11

DRG.NO.

IF IN DOUBT ASK

ISSUE	REVISION	CLASS
-------	----------	-------

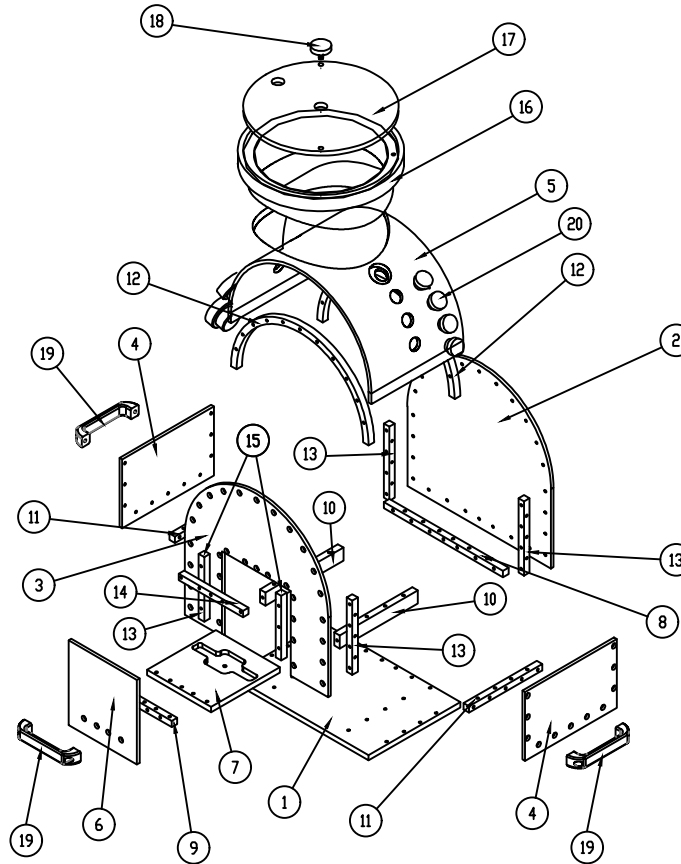

ITEM NO.	PART NUMBER	QTY.
1	BOTTOM PLATE	1
2	BACK PLATE	1
3	FRONT PLATE	1
4	SIDE PLATE	2
5	C PLATE	1
6	SLIDER PLATE	1
7	SLIDER JOINT PLATE	1
8	BACK PLATE MOUNTING	1
9	CENTER MOUNTING SLIDER JOINT	1
10	RAIL PLATE	2
11	SIDE MOUNTING PLATE	2
12	C SQUARE PLATE	2
13	JOINT PLATE	4
14	FRONT UPPER PLATE JOINT	1
15	JOINT PLATE1.0	2
16	TOP RISER	1
17	TOP RISER PLATE	1
18	KNOB	1
19	U HANDLE	3
20	HOLE HOLDER	8

ISSUE	'A'				
DATE	00.00.0000				
REF.NO.					
DRN.	name				
CHD.	name				
MATL.	name				
DQAG	name				
APPD.	name				

UNLESS OTHERWISE STATED

1. DIMENSIONS ARE IN mm.
2. LIMIT ± 0.2 ; $\pm 30'$
3. SURFACE FINISH $\sqrt{16}$ (CLA)
4. ROUND OFF SHARP EDGES
5. METRIC THREADS AS PER IS:4218
6. FINISHED SIZES SHOWN (AFTER PLATING)
7. DO NOT SCALE

MATERIAL	SPEC.	HEAT TRT.	SPEC.	PROTECTIVE TRT.	SPEC.
AL6061T6	---	---	---	---	---

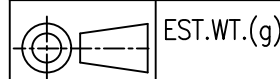

LL RIG - BOM
LAP LIGHT INTENSITY TEST RIG

SCALE	1 : 5	SHEET	11 OF 20	ASSY.NO.
-------	-------	-------	----------	----------



Aerospace Systems Equipment
Research and Design Centre
H A L, LUCKNOW

DRG.NO.
OP 33M.01-BOM

OP 33M.01-01

DRG.NO.

IF IN DOUBT ASK

ISSUE	REVISION	CLASS
-------	----------	-------

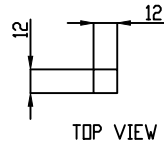

TOP VIEW

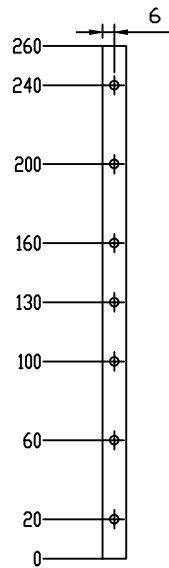

FRONT VIEW

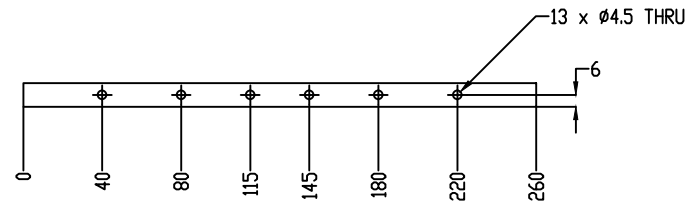

SIDE VIEW

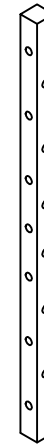

ISOMETRIC VIEW

ISSUE	'A'				
DATE	00.00.0000				
REF.NO.					
DRN.	name				
CHD.	name				
MATL.	name				
DQAG	name				
APPD.	name				

UNLESS OTHERWISE STATED

1. DIMENSIONS ARE IN mm.
2. LIMIT ± 0.2 ; $\pm 30'$
3. SURFACE FINISH $\sqrt{16}$ (CLA)
4. ROUND OFF SHARP EDGES
5. METRIC THREADS AS PER IS:4218
6. FINISHED SIZES SHOWN (AFTER PLATING)
7. DO NOT SCALE

MATERIAL	SPEC.	HEAT TRT.	SPEC.	PROTECTIVE TRT.	SPEC.
AL6061T6	----	----	----	----	----

	EST.WT.(g)	BACK MOUNTING PLATE	
		LAP LIGHT INTENSITY TEST RIG	

SCALE	1 : 2	SHEET	3 OF 21	ASSY.NO.
-------	-------	-------	---------	----------

	Aerospace Systems Equipment Research and Design Centre H A L, LUCKNOW	DRG.NO. OP 33M.01-01
--	---	--------------------------------

OP 33M.01-03

DRG.NO.

IF IN DOUBT ASK

ISSUE	REVISION	CLASS

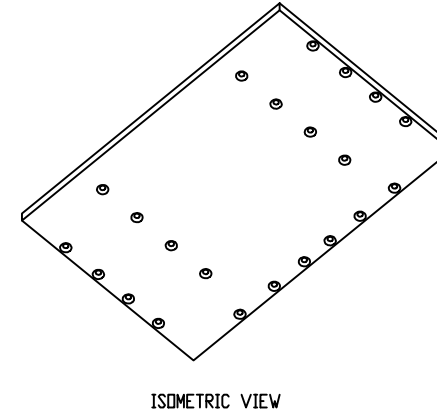
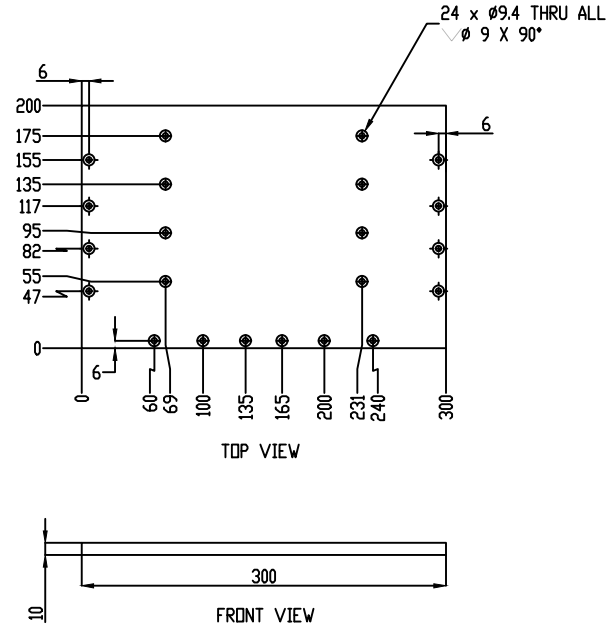

ISSUE	'A'				
DATE	00.00.0000				
REF.NO.					
DRN.	name				
CHD.	name				
MATL.	name				
DQAG	name				
APPD.	name				

UNLESS OTHERWISE STATED

1. DIMENSIONS ARE IN mm.
2. LIMIT ± 0.2 ; $\pm 30'$
3. SURFACE FINISH $\sqrt{16}$ (CLA)
4. ROUND OFF SHARP EDGES
5. METRIC THREADS AS PER IS:4218
6. FINISHED SIZES SHOWN (AFTER PLATING)
7. DO NOT SCALE

MATERIAL	SPEC.	HEAT TRT.	SPEC.	PROTECTIVE TRT.	SPEC.
AL6061T6	----	----	----	----	----
	EST.WT.(g)	BOTTOM PLATE LAP LIGHT INTENSITY TEST RIG			
SCALE	1 : 3	SHEET	5 OF 21	ASSY.NO.	
	Aerospace Systems Equipment Research and Design Centre H A L, LUCKNOW			DRG.NO. OP 33M.01-03	

OP 33M.01-04

DRG.NO.

IF IN DOUBT ASK

ISSUE	REVISION	CLASS
-------	----------	-------

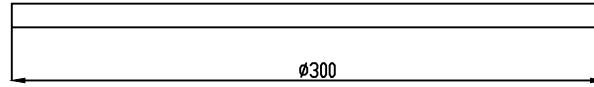

TOP VIEW

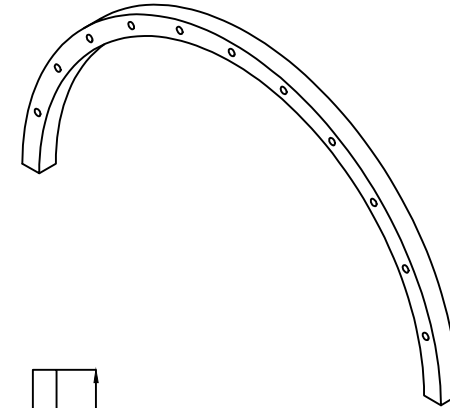

ISOMETRIC VIEW

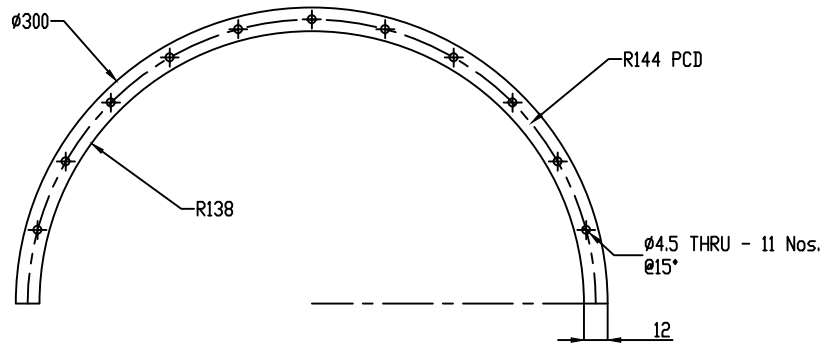

FRONT VIEW

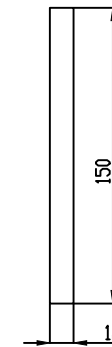

SIDE VIEW

ISSUE	'A'					
DATE	00.00.0000					
REF.NO.						
DRN.	name					
CHD.	name					
MATL.	name					
DQAG	name					
APPD.	name					

UNLESS OTHERWISE STATED

1. DIMENSIONS ARE IN mm.
2. LIMIT ± 0.2 ; $\pm 30'$
3. SURFACE FINISH $\sqrt{16}$ (CLA)
4. ROUND OFF SHARP EDGES
5. METRIC THREADS AS PER IS:4218
6. FINISHED SIZES SHOWN (AFTER PLATING)
7. DO NOT SCALE

MATERIAL	SPEC.	HEAT TRT.	SPEC.	PROTECTIVE TRT.	SPEC.
AL6061T6	----	----	----	----	----

	EST.WT.(g)	C SQUARE PLATE	
		LAP LIGHT INTENSITY TEST RIG	

SCALE 1 : 2	SHEET 6 OF 21	ASSY.NO.
-------------	---------------	----------

	Aerospace Systems Equipment Research and Design Centre H A L, LUCKNOW	DRG.NO. OP 33M.01- 04
--	---	--------------------------

OP 33M.01-05

IF IN DOUBT ASK

DRG.NO.

ISSUE	REVISION	CLASS
-------	----------	-------

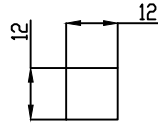

TOP VIEW

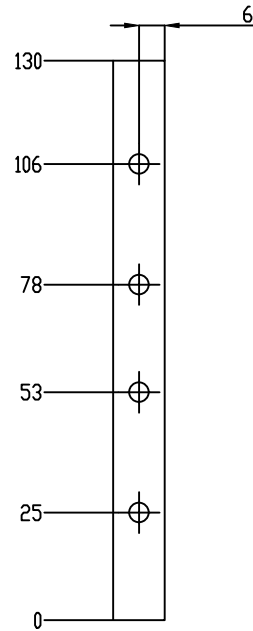

FRONT VIEW

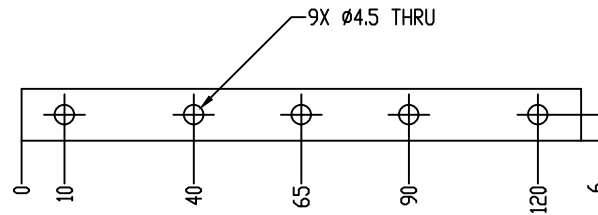

SIDE VIEW

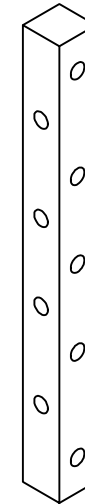

ISOMETRIC VIEW

ISSUE	'A'				
DATE	00.00.0000				
REF.NO.					
DRN.	name				
CHD.	name				
MATL.	name				
DQAG	name				
APPD.	name				

UNLESS OTHERWISE STATED

1. DIMENSIONS ARE IN mm.
2. LIMIT ± 0.2 ; $\pm 30'$
3. SURFACE FINISH $\sqrt{16}$ (CLA)
4. ROUND OFF SHARP EDGES
5. METRIC THREADS AS PER IS:4218
6. FINISHED SIZES SHOWN (AFTER PLATING)
7. DO NOT SCALE

MATERIAL	SPEC.	HEAT TRT.	SPEC.	PROTECTIVE TRT.	SPEC.
AL6061T6	----	----	----	----	----
	EST.WT.(g)	CENTER MOUNTING SLIDER JOINT LAP LIGHT INTENSITY TEST RIG			
SCALE	1 : 1	SHEET	07 OF 21	ASSY.NO.	
	Aerospace Systems Equipment Research and Design Centre H A L, LUCKNOW			DRG.NO. OP 33M.01-05	

90-33M.01-06

DRG.NO.

IF IN DOUBT ASK

ISSUE	REVISION	CLASS
-------	----------	-------

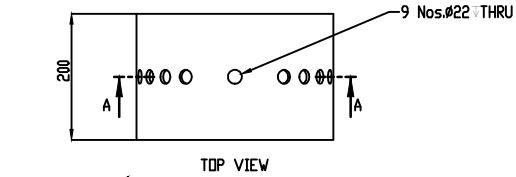

TOP VIEW

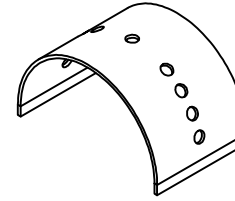

ISOMETRIC VIEW

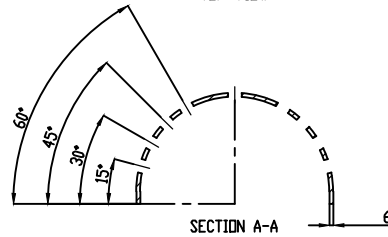

SECTION A-A

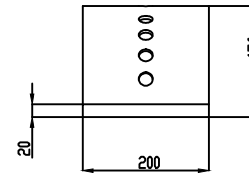

LEFT VIEW

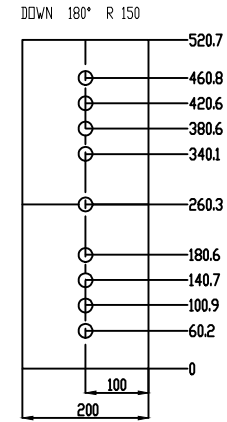

FLAT PATTERN

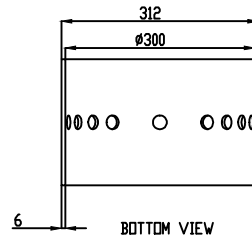

BOTTOM VIEW

ISSUE	'A'				
DATE	00.00.0000				
REF.NO.					
DRN.	name				
CHD.	name				
MATL.	name				
DQAG	name				
APPD.	name				

UNLESS OTHERWISE STATED

1. DIMENSIONS ARE IN mm.
2. LIMIT ± 0.2 ; $\pm 30'$
3. SURFACE FINISH $\sqrt{16}$ (CLA)
4. ROUND OFF SHARP EDGES
5. METRIC THREADS AS PER IS:4218
6. FINISHED SIZES SHOWN (AFTER PLATING)
7. DO NOT SCALE

MATERIAL	SPEC.	HEAT TRT.	SPEC.	PROTECTIVE TRT.	SPEC.
AL6061T6	---	---	---	---	---

	EST.WT.(g)	C PLATE LAP LIGHT INTENSITY TEST RIG	
		SCALE 1 : 5	SHEET 08 OF 21

	Aerospace Systems Equipment Research and Design Centre H A L, LUCKNOW	ASSY.NO.
		DRG.NO. OP 33M.01- 06

OP 33M.01-07

DRG.NO.

IF IN DOUBT ASK

ISSUE	REVISION	CLASS
-------	----------	-------

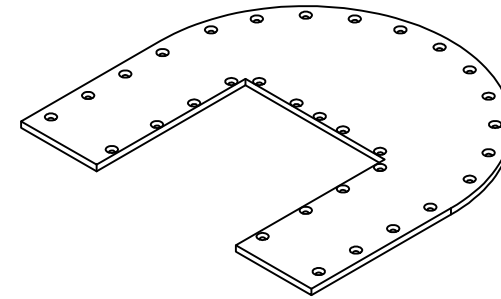
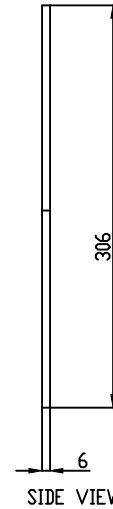
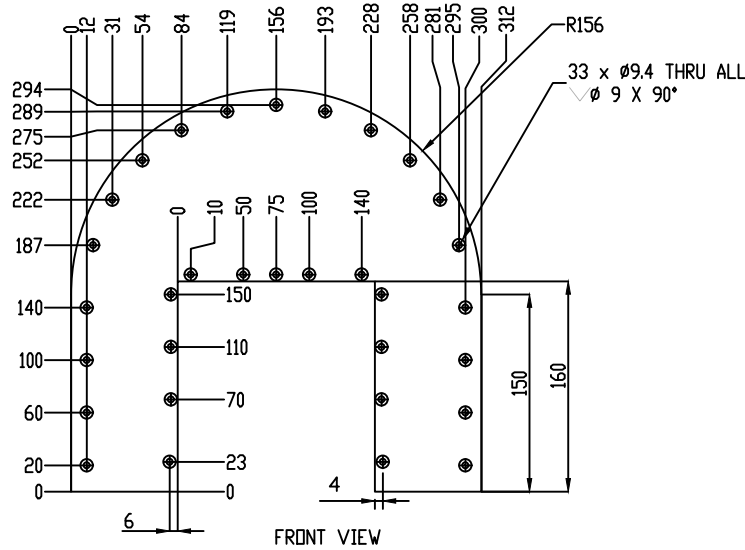

ISOMETRIC VIEW

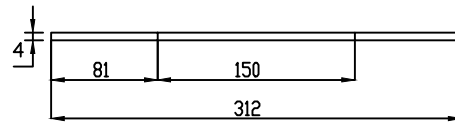

TOP VIEW

NOTE:

The angle indications are given in drawing no. OP 33M.01-18.
SHEET SIZE : 306 X 312 MM

ISSUE	'A'				
DATE	00.00.0000				
REF.NO.					
DRN.	name				
CHD.	name				
MATL.	name				
DQAG	name				
APPD.	name				

UNLESS OTHERWISE STATED

1. DIMENSIONS ARE IN mm.
2. LIMIT ± 0.2 ; $\pm 30'$
3. SURFACE FINISH $\sqrt{16}$ (CLA)
4. ROUND OFF SHARP EDGES
5. METRIC THREADS AS PER IS:4218
6. FINISHED SIZES SHOWN (AFTER PLATING)
7. DO NOT SCALE

MATERIAL	SPEC.	HEAT TRT.	SPEC.	PROTECTIVE TRT.	SPEC.
AL6061T6	----	----	----	----	----
	EST.WT.(g)	FRONT PLATE LAP LIGHT INTENSITY TEST RIG			
SCALE	1 : 2	SHEET	09 OF 21	ASSY.NO.	
	Aerospace Systems Equipment Research and Design Centre H A L, LUCKNOW			DRG.NO. OP 33M.01-07	

OP 33M.01-08

DRG.NO.

IF IN DOUBT ASK

ISSUE	REVISION	CLASS
-------	----------	-------

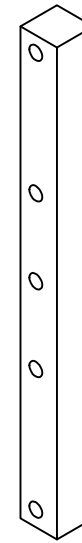
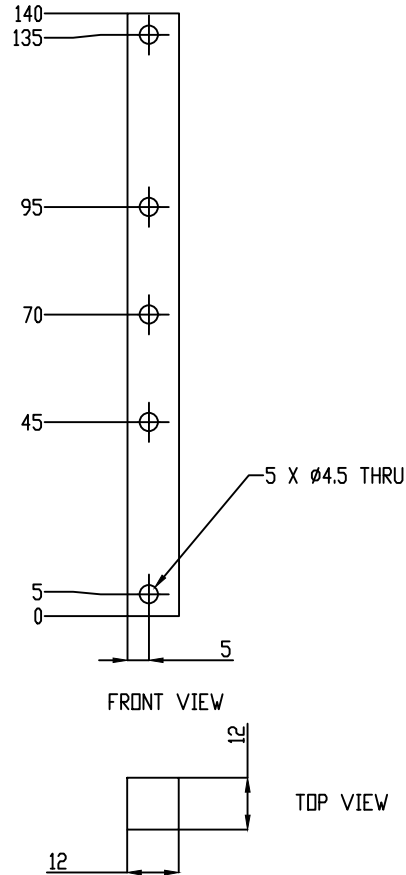

ISSUE	'A'				
DATE	00.00.0000				
REF.NO.					
DRN.	name				
CHD.	name				
MATL.	name				
DQAG	name				
APPD.	name				

UNLESS OTHERWISE STATED

1. DIMENSIONS ARE IN mm.
2. LIMIT ± 0.2 ; $\pm 30'$
3. SURFACE FINISH $\sqrt{16}$ (CLA)
4. ROUND OFF SHARP EDGES
5. METRIC THREADS AS PER IS:4218
6. FINISHED SIZES SHOWN (AFTER PLATING)
7. DO NOT SCALE

MATERIAL	SPEC.	HEAT TRT.	SPEC.	PROTECTIVE TRT.	SPEC.
AL6061T6	----	----	----	----	----
	EST.WT.(g)	FRONT UPPER PLATE JOINT LAP LIGHT INTENSITY TEST RIG			
SCALE	1 : 1	SHEET	10 OF 21	ASSY.NO.	
	Aerospace Systems Equipment Research and Design Centre H A L, LUCKNOW			DRG.NO. OP 33M.01-08	

A
B
C
D

OP 33M.01-09

IF IN DOUBT ASK

DRG.NO.

ISSUE	REVISION	CLASS
-------	----------	-------

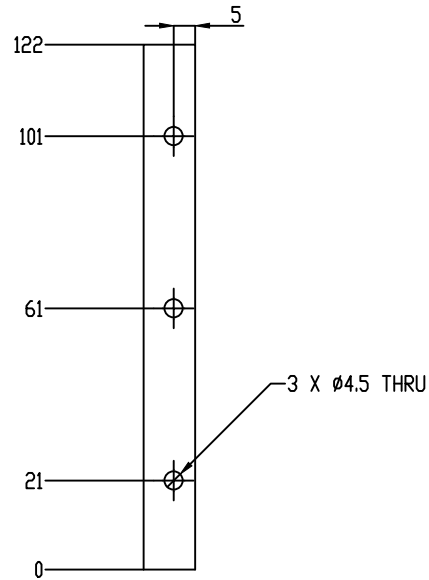

FRONT VIEW

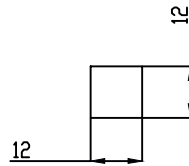

BOTTOM VIEW

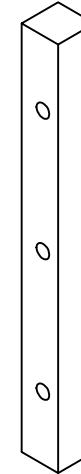

ISOMETRIC VIEW

ISSUE	'A'					
DATE	00.00.0000					
REF.NO.						
DRN.	name					
CHD.	name					
MATL.	name					
DQAG	name					
APPD.	name					

UNLESS OTHERWISE STATED

1. DIMENSIONS ARE IN mm.
2. LIMIT ± 0.2 ; $\pm 30'$
3. SURFACE FINISH $\sqrt{16}$ (CLA)
4. ROUND OFF SHARP EDGES
5. METRIC THREADS AS PER IS:4218
6. FINISHED SIZES SHOWN (AFTER PLATING)
7. DO NOT SCALE

MATERIAL	SPEC.	HEAT TRT.	SPEC.	PROTECTIVE TRT.	SPEC.
AL6061T6	----	----	----	----	----



JOINT PLATE 1.0
LAP LIGHT INTENSITY TEST RIG

SCALE	1 : 1	SHEET	11 OF 21	ASSY.NO.
-------	-------	-------	----------	----------

	Aerospace Systems Equipment Research and Design Centre H A L, LUCKNOW	DRG.NO. OP 33M.01-09
--	---	--------------------------------

OP 33M.01-10

DRG.NO.

ISSUE	REVISION	CLASS
-------	----------	-------

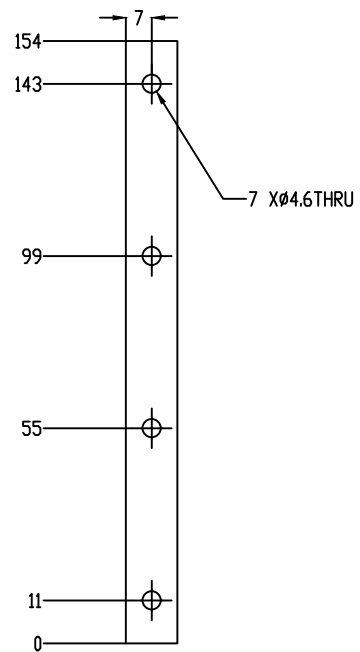

FRONT VIEW

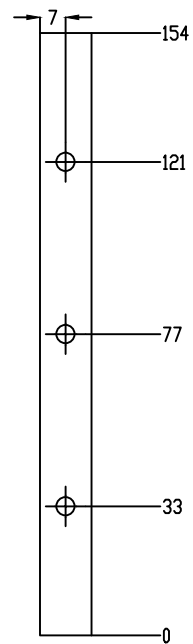

SIDE VIEW

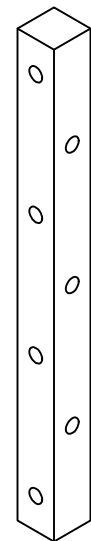

ISOMETRIC VIEW

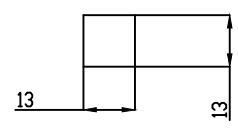

TOP VIEW

IF IN DOUBT ASK

A
B
C
D

ISSUE	'A'				
DATE	00.00.0000				
REF.NO.					
DRN.	name				
CHD.	name				
MATL.	name				
DQAG	name				
APPD.	name				

- UNLESS OTHERWISE STATED**
- DIMENSIONS ARE IN mm.
 - LIMIT ± 0.2 ; $\pm 30'$
 - SURFACE FINISH $\sqrt{16}$ (CLA)
 - ROUND OFF SHARP EDGES
 - METRIC THREADS AS PER IS:4218
 - FINISHED SIZES SHOWN (AFTER PLATING)
 - DO NOT SCALE

MATERIAL	SPEC.	HEAT TRT.	SPEC.	PROTECTIVE TRT.	SPEC.
AL6061T6	---	---	---	---	---
	EST.WT.(g)	JOINT PLATE LAP LIGHT INTENSITY TEST RIG			
SCALE 1 : 1	SHEET 12 OF 21	ASSY.NO.			
	Aerospace Systems Equipment Research and Design Centre H A L, LUCKNOW	DRG.NO. OP 33M.01- 10			

OP 33M.01-11

DRG.NO.

IF IN DOUBT ASK

ISSUE	REVISION	CLASS
-------	----------	-------

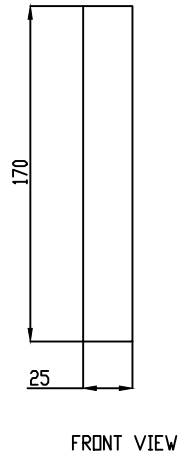
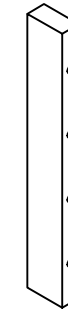
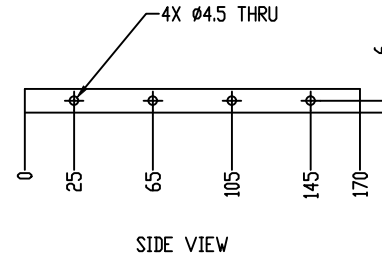
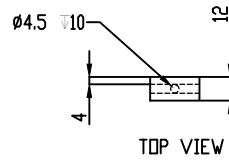

ISSUE	'A'					
DATE	00.00.0000					
REF.NO.						
DRN.	name					
CHD.	name					
MATL.	name					
DQAG	name					
APPD.	name					

UNLESS OTHERWISE STATED

- DIMENSIONS ARE IN mm.
- LIMIT ± 0.2 ; $\pm 30'$
- SURFACE FINISH $\sqrt{16}$ (CLA)
- ROUND OFF SHARP EDGES
- METRIC THREADS AS PER IS:4218
- FINISHED SIZES SHOWN (AFTER PLATING)
- DO NOT SCALE

MATERIAL	SPEC.	HEAT TRT.	SPEC.	PROTECTIVE TRT.	SPEC.
AL6061T6	---	---	---	---	---

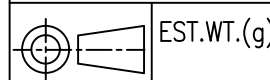

EST.WT.(g)

RAIL PLATE
LAP LIGHT INTENSITY TEST RIG

SCALE	1 : 2	SHEET	13 OF 21	ASSY.NO.
-------	-------	-------	----------	----------



Aerospace Systems Equipment
Research and Design Centre
H A L, LUCKNOW

DRG.NO.
OP 33M.01- 11

OP 33M.01-12

DRG.NO.

ISSUE	REVISION	CLASS
-------	----------	-------

IF IN DOUBT ASK

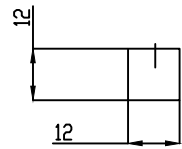

TOP VIEW

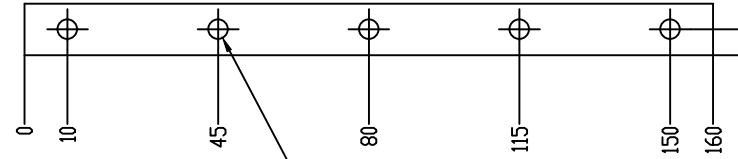

SIDE VIEW

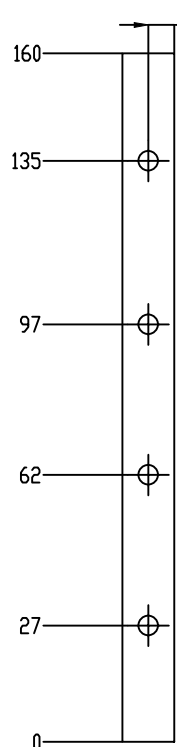

FRONT VIEW

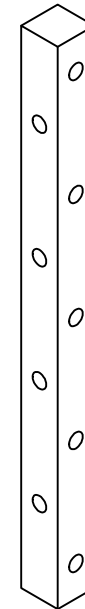

ISOMETRIC VIEW

ISSUE	'A'				
DATE	00.00.0000				
REF.NO.					
DRN.	name				
CHD.	name				
MATL.	name				
DQAG	name				
APPD.	name				

UNLESS OTHERWISE STATED

1. DIMENSIONS ARE IN mm.
2. LIMIT ± 0.2 ; $\pm 30'$
3. SURFACE FINISH $\sqrt{16}$ (CLA)
4. ROUND OFF SHARP EDGES
5. METRIC THREADS AS PER IS:4218
6. FINISHED SIZES SHOWN (AFTER PLATING)
7. DO NOT SCALE

MATERIAL	SPEC.	HEAT TRT.	SPEC.	PROTECTIVE TRT.	SPEC.
AL6061T6	----	----	----	----	----

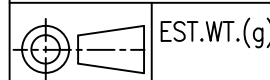

SIDE MOUNTING PLATE
LAP LIGHT INTENSITY TEST RIG

SCALE	1 : 1	SHEET	14 OF 21	ASSY.NO.
-------	-------	-------	----------	----------

Aerospace Systems Equipment
Research and Design Centre
H A L, LUCKNOW

DRG.NO.
OP 33M.01-12

DRG.NO.
OP 33M.01-13

IF IN DOUBT ASK

ISSUE	REVISION	CLASS
-------	----------	-------

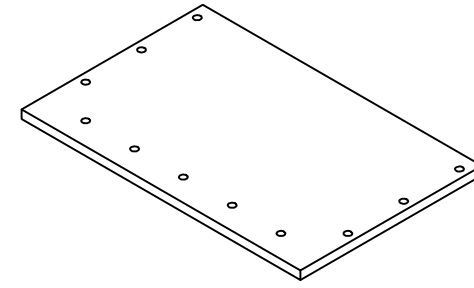
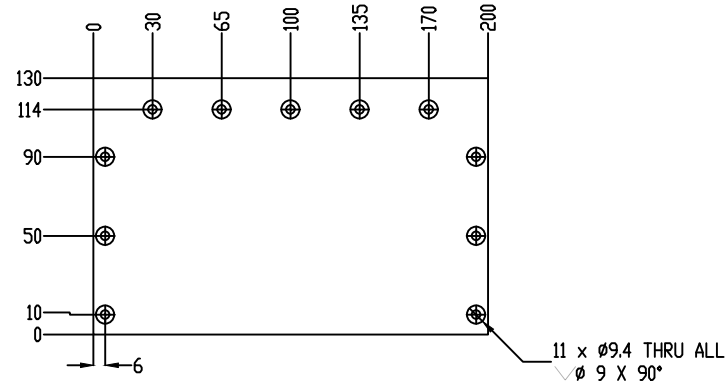

ISOMETRIC VIEW

TOP VIEW

FRONT VIEW

ISSUE	'A'				
DATE	00.00.0000				
REF.NO.					
DRN.	name				
CHD.	name				
MATL.	name				
DQAG	name				
APPD.	name				

UNLESS OTHERWISE STATED

- DIMENSIONS ARE IN mm.
- LIMIT ± 0.2 ; $\pm 30'$
- SURFACE FINISH $\sqrt{16}$ (CLA)
- ROUND OFF SHARP EDGES
- METRIC THREADS AS PER IS:4218
- FINISHED SIZES SHOWN (AFTER PLATING)
- DO NOT SCALE

MATERIAL	SPEC.	HEAT TRT.	SPEC.	PROTECTIVE TRT.	SPEC.
AL6061T6	----	----	----	----	----

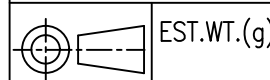

EST.WT.(g)

SIDE PLATE
LAP LIGHT INTENSITY TEST RIG

SCALE	1 : 2	SHEET	15 OF 21	ASSY.NO.
-------	-------	-------	----------	----------



Aerospace Systems Equipment
Research and Design Centre
H A L, LUCKNOW

DRG.NO.
OP 33M.01-13

OP 33M.01-14

DRG.NO.

IF IN DOUBT ASK

ISSUE	REVISION	CLASS
-------	----------	-------

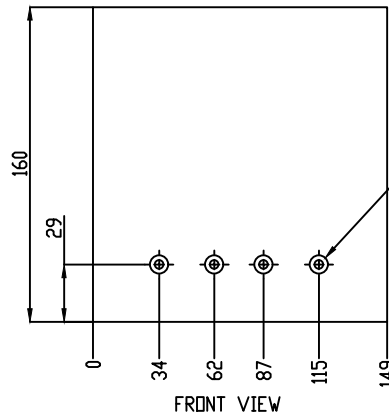

4 x Ø9.4 THRU ALL
 $\sqrt{\text{V}}$ Ø 9 X 90°

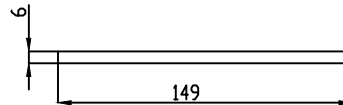
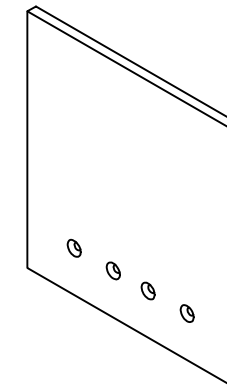

ISSUE	'A'				
DATE	00.00.0000				
REF.NO.					
DRN.	name				
CHD.	name				
MATL.	name				
DQAG	name				
APPD.	name				

UNLESS OTHERWISE STATED

1. DIMENSIONS ARE IN mm.
2. LIMIT ± 0.2 ; $\pm 30'$
3. SURFACE FINISH $\sqrt{\text{V}}$ 16 (CLA)
4. ROUND OFF SHARP EDGES
5. METRIC THREADS AS PER IS:4218
6. FINISHED SIZES SHOWN (AFTER PLATING)
7. DO NOT SCALE

MATERIAL	SPEC.	HEAT TRT.	SPEC.	PROTECTIVE TRT.	SPEC.
AL6061T6	----	----	----	----	----

	EST.WT.(Kg)	SLIDER PLATE	
		LAP LIGHT INTENSITY TEST RIG	

SCALE 1 : 2	SHEET 16 OF 21	ASSY.NO.
-------------	----------------	----------

	Aerospace Systems Equipment Research and Design Centre H A L, LUCKNOW	DRG.NO.
		OP 33M.01- 14

OP 33M.01-15

DRG.NO.

IF IN DOUBT ASK

ISSUE	REVISION	CLASS
-------	----------	-------

R5TYP.

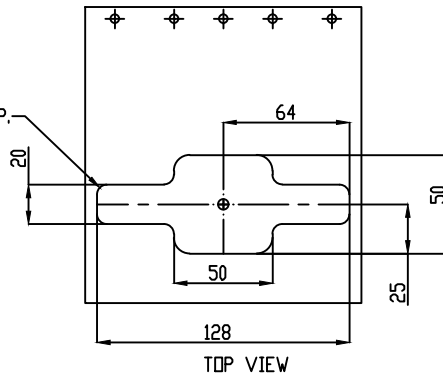

TOP VIEW

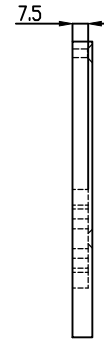

SIDE VIEW

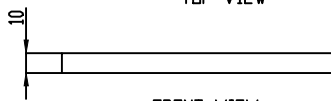

FRONT VIEW

6 x $\varnothing 9.4$ THRU ALL
 $\surd \varnothing 9 \times 90^\circ$

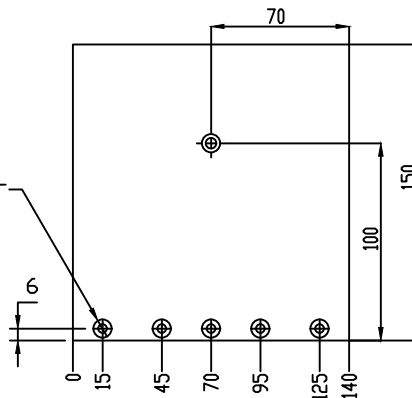

BOTTOM VIEW

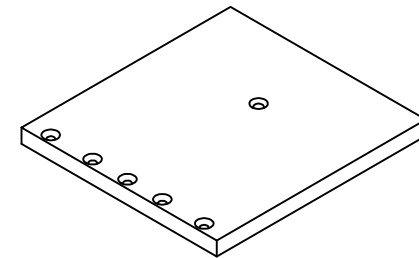

ISOMETRIC VIEW

NOTE:
 The angle indications are given in drawing no. DP 33M.01-19

ISSUE	'A'				
DATE	00.00.0000				
REF.NO.					
DRN.	name				
CHD.	name				
MATL.	name				
DQAG	name				
APPD.	name				

UNLESS OTHERWISE STATED

1. DIMENSIONS ARE IN mm.
2. LIMIT ± 0.2 ; $\pm 30'$
3. SURFACE FINISH $\surd 16$ (CLA)
4. ROUND OFF SHARP EDGES
5. METRIC THREADS AS PER IS:4218
6. FINISHED SIZES SHOWN (AFTER PLATING)
7. DO NOT SCALE

MATERIAL	SPEC.	HEAT TRT.	SPEC.	PROTECTIVE TRT.	SPEC.
AL6061T6	----	----	----	----	----
	EST.WT.(g)	SLIDER JOINT PLATE LAP LIGHT INTENSITY TEST RIG			
SCALE	1 : 2	SHEET	17 OF 21	ASSY.NO.	
	Aerospace Systems Equipment Research and Design Centre H A L, LUCKNOW			DRG.NO. OP 33M.01-15	

OP 33M.01-16

DRG.NO.

IF IN DOUBT ASK

ISSUE	REVISION	CLASS
-------	----------	-------

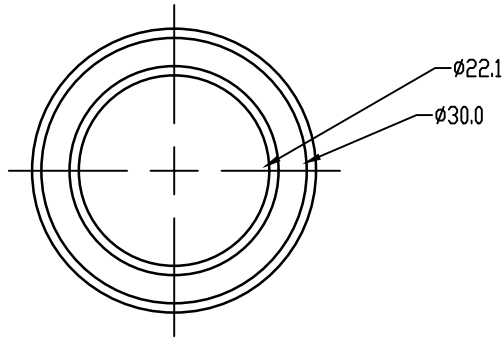

TOP VIEW

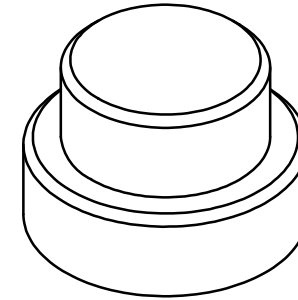

ISOMETRIC VIEW

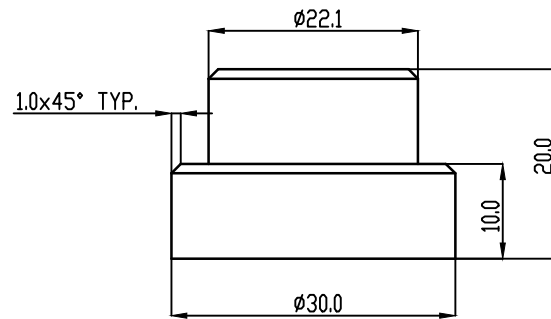

FRONT VIEW

ISSUE	'A'				
DATE	00.00.0000				
REF.NO.					
DRN.	name				
CHD.	name				
MATL.	name				
DQAG	name				
APPD.	name				

UNLESS OTHERWISE STATED

- DIMENSIONS ARE IN mm.
- LIMIT ± 0.2 ; $\pm 30'$
- SURFACE FINISH $\sqrt{16}$ (CLA)
- ROUND OFF SHARP EDGES
- METRIC THREADS AS PER IS:4218
- FINISHED SIZES SHOWN (AFTER PLATING)
- DO NOT SCALE

MATERIAL	SPEC.	HEAT TRT.	SPEC.	PROTECTIVE TRT.	SPEC.
AL6061T6	----	----	----	----	----

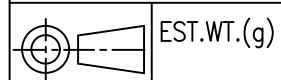

HOLE HOLDER
LAP LIGHT INTENSITY TEST RIG

SCALE	2 : 1	SHEET	18 OF 21	ASSY.NO.
-------	-------	-------	----------	----------



Aerospace Systems Equipment
Research and Design Centre
H A L, LUCKNOW

DRG.NO.
OP 33M.01- 16

OP 33M.01-17

DRG.NO.

IF IN DOUBT ASK

ISSUE	REVISION	CLASS
-------	----------	-------

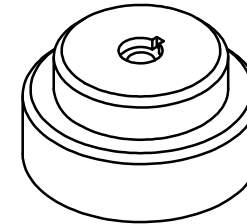
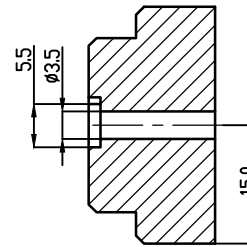
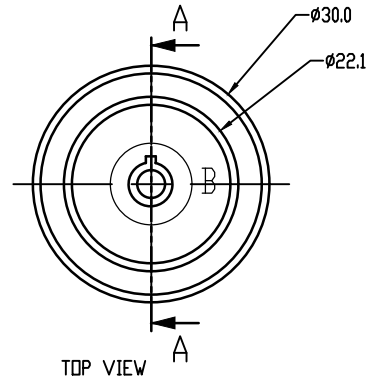

ISOMETRIC VIEW

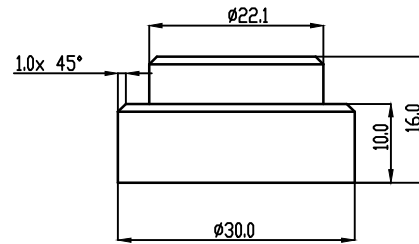

FRONT VIEW

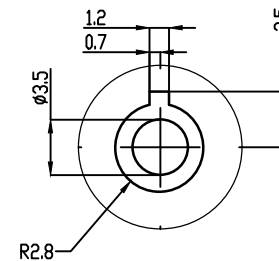

DETAIL B

SCALE 4 : 1

ISSUE	'A'				
DATE	00.00.0000				
REF.NO.					
DRN.	name				
CHD.	name				
MATL.	name				
DQAG	name				
APPD.	name				

UNLESS OTHERWISE STATED

- DIMENSIONS ARE IN mm.
- LIMIT ± 0.2 ; $\pm 30'$
- SURFACE FINISH $\sqrt{16}$ (CLA)
- ROUND OFF SHARP EDGES
- METRIC THREADS AS PER IS:4218
- FINISHED SIZES SHOWN (AFTER PLATING)
- DO NOT SCALE

MATERIAL	SPEC.	HEAT TRT.	SPEC.	PROTECTIVE TRT.	SPEC.
AL6061T6	---	---	---	---	---

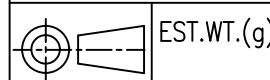

EST. WT. (g)

LENS HOLDER
LAP LIGHT INTENSITY TEST RIG

SCALE	2 : 1	SHEET	19 OF 21	ASSY.NO.
-------	-------	-------	----------	----------



Aerospace Systems Equipment
Research and Design Centre
H A L, LUCKNOW

DRG.NO.
OP 33M.01-17

OP 33M.01-18

DRG.NO.

IF IN DOUBT ASK

ISSUE	REVISION	CLASS

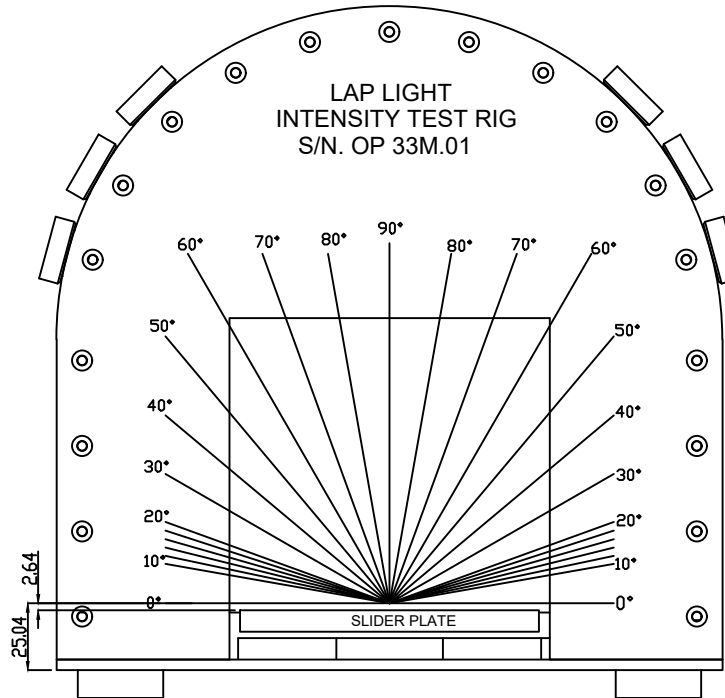

ISSUE	'A'				
DATE	00.00.0000				
REF.NO.					
DRN.	name				
CHD.	name				
MATL.	name				
DQAG	name				
APPD.	name				

UNLESS OTHERWISE STATED

1. DIMENSIONS ARE IN mm.
2. LIMIT ± 0.2 ; $\pm 30'$
3. SURFACE FINISH $\sqrt{16}$ (CLA)
4. ROUND OFF SHARP EDGES
5. METRIC THREADS AS PER IS:4218
6. FINISHED SIZES SHOWN (AFTER PLATING)
7. DO NOT SCALE

MATERIAL	SPEC.	HEAT TRT.	SPEC.	PROTECTIVE TRT.	SPEC.
AL6061T6	----	----	----	----	----
	EST.WT.(g)	FRONT PLATE ANGLE VIEW LAP LIGHT INTENSITY TEST RIG			
SCALE 1 : 1	SHEET 19 OF 21	ASSY.NO.			
	Aerospace Systems Equipment Research and Design Centre H A L, LUCKNOW	DRG.NO. OP 33M.01- 18			

OP 33M.01- 19

DRG.NO.

IF IN DOUBT ASK

ISSUE	REVISION	CLASS
-------	----------	-------

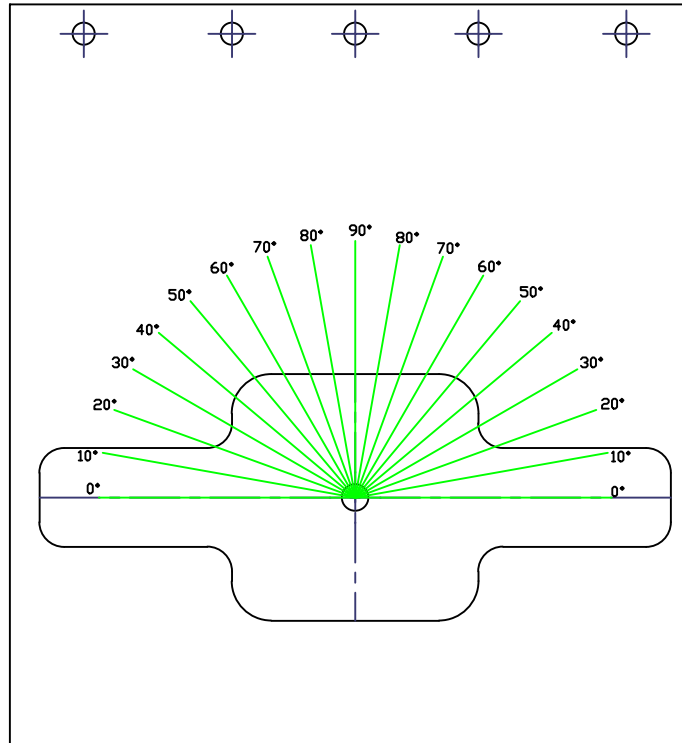

ISSUE	'A'				
DATE	00.00.0000				
REF.NO.					
DRN.	name				
CHD.	name				
MATL.	name				
DQAG	name				
APPD.	name				

UNLESS OTHERWISE STATED

1. DIMENSIONS ARE IN mm.
2. LIMIT ± 0.2 ; $\pm 30'$
3. SURFACE FINISH $\sqrt{16}$ (CLA)
4. ROUND OFF SHARP EDGES
5. METRIC THREADS AS PER IS:4218
6. FINISHED SIZES SHOWN (AFTER PLATING)
7. DO NOT SCALE

MATERIAL	SPEC.	HEAT TRT.	SPEC.	PROTECTIVE TRT.	SPEC.
AL6061T6	----	----	----	----	----

	EST.WT.(g)	SLIDER JOINT PLATE ANGLE VIEW LAP LIGHT INTENSITY TEST RIG
--	------------	---

SCALE 1 : 2	SHEET 21 OF 21	ASSY.NO.
-------------	----------------	----------

	Aerospace Systems Equipment Research and Design Centre H A L, LUCKNOW	DRG.NO. OP 33M.01- 19
--	---	--------------------------